



Adelaide Expo Hire

31 Deeds Road, North Plympton, S.A. 5037
 Phone: (08) 8350 2300 Fax: (08) 8350 2301
 E-mail: adexpo@aeh.com.au
www.aeh.com.au

NOTES:

All numbered areas are 3m x 2m booths
 There are 22 booths
 There are two catering stations
 Plenary Sessions are in Ballrooms 4 & 5

KEY:

- BOOTHS
- FASCIAS
- DOOR TRACK

- 3 PHASE POWER

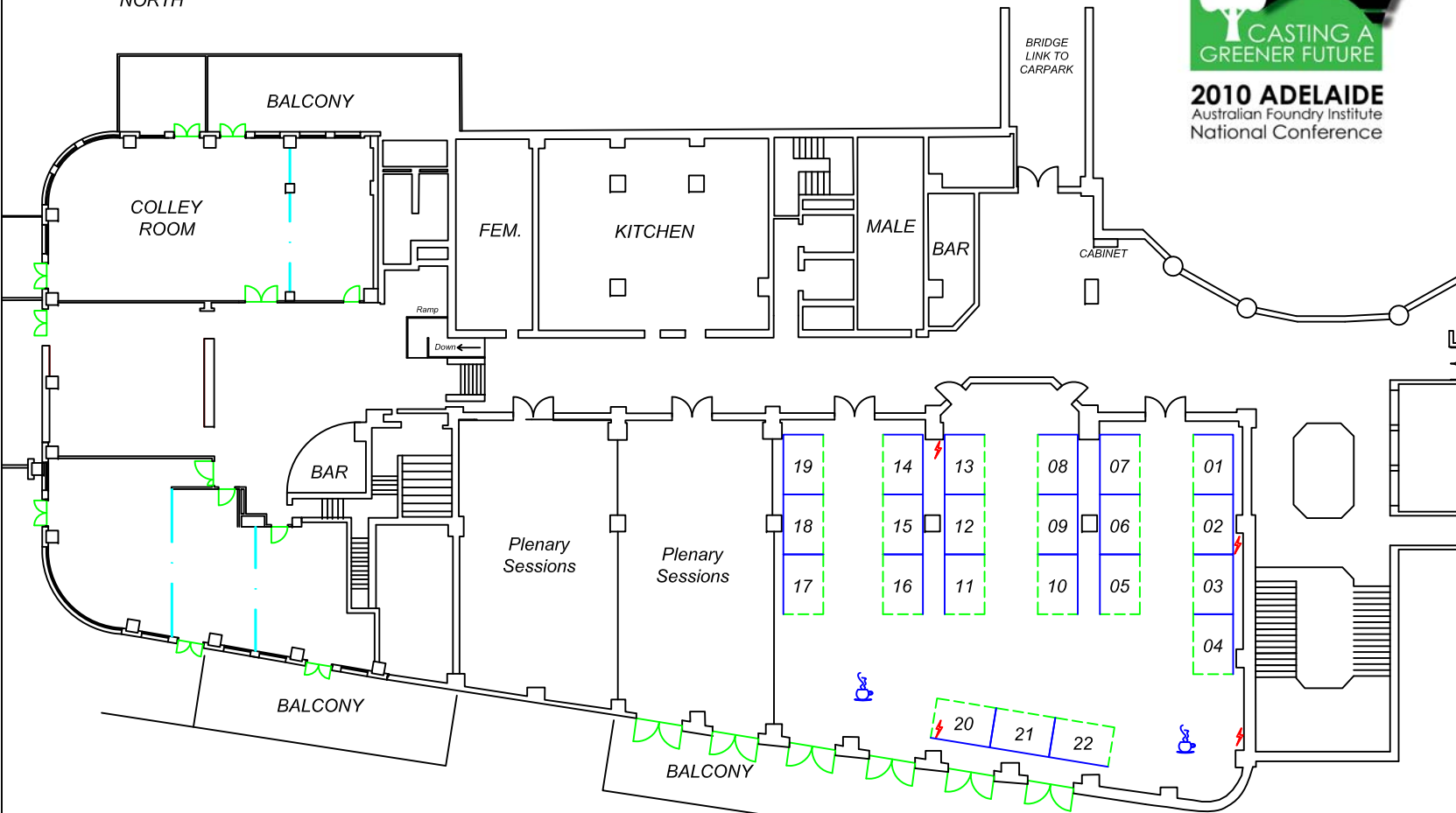
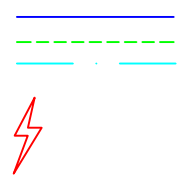

Proposed Floorplan for the Australian Foundry Institute

17th - 20th October 2010

Venue: **STAMFORD GRAND Ballrooms 1-3**

Job No: 33669

Drawing No: AO5136

Date: 18.09.09

Drawn By: LW

